

Surge protective device for LED light
Model No.: FLP05-275i-D

Version: B-3



- New designed series connected surge protection module, Type 2 (or 3) LED surge protector. Compact design
- Specifically for outdoor and commercial LED lighting applications, LED signage and traffic light manufacturers, including roadway lighting, parking garage lighting, wash wall lighting, traffic lighting, flood lighting, digital signage, street lightning, and tunneal lighting.
- I_{max} 15kA lightning surge protection.
- Varistor with built-in temperature tripping protection
- Equipped with overload protection. Power supply disconnected when failure occurs
- State indication
- DIN rail installation

1.Coding

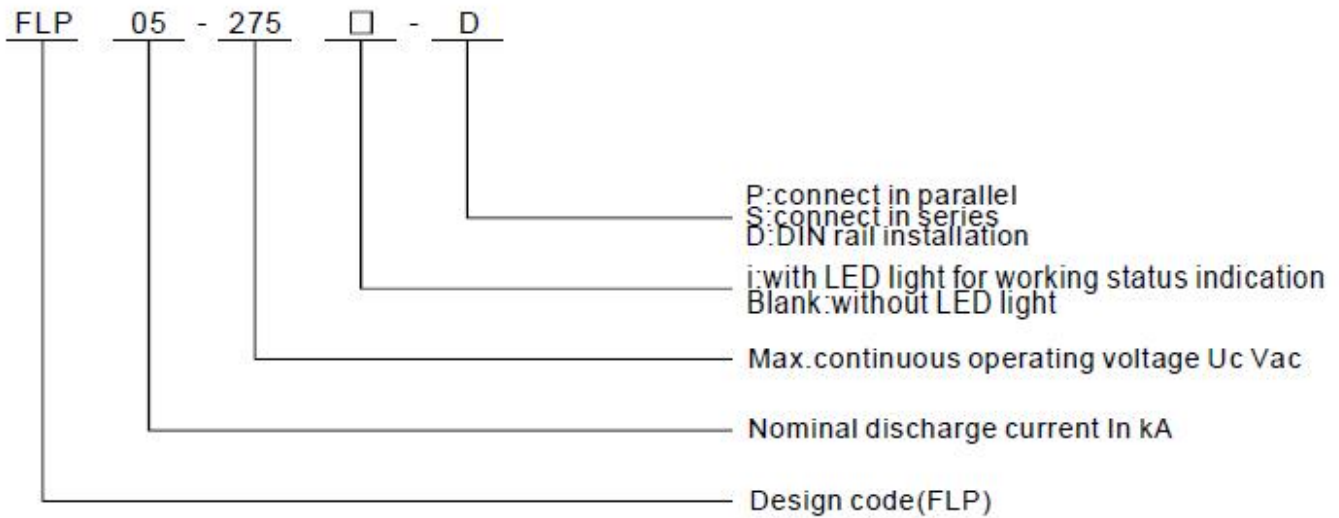

2. Dimension

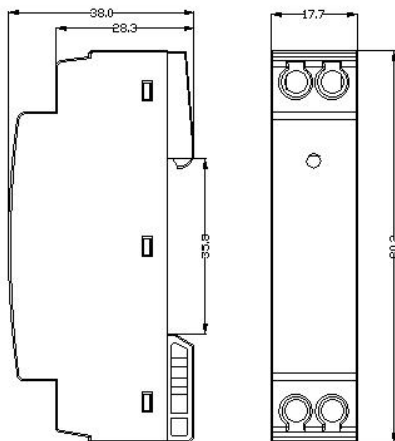

3. Circuit

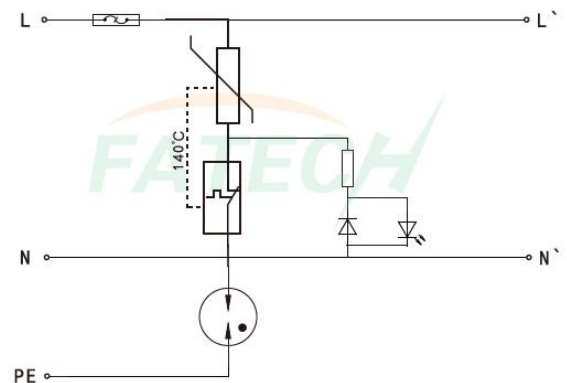

FATECH ELECTRONIC (FOSHAN) CO., LTD.

Add: Bldg D7, Guangdong New Light Production Base, Luocun, Shishan Town, Nanhai District, Foshan City, Guangdong China.

Tel: +86 757 86718031 Fax: +86 757 83557686

Web: www.fatech-surge-protection.com, www.fatech-spd.cn

Email: sales@fatech-surge-protection.com, sales@fatech-spd.cn

4. Electrical parameters

Model. No.	FLP05-275i-D	
SPD protection conforms to EN 61643-11	Type2+3	
SPD installation type conforms to EN 61643-1	ClassII+III	
Protection level conforms to DIN VED 0675-6	C+D	
Type of Network	LED light	
Protection mode	L-N , N-PE , L-PE	
Nominal Voltage 50(60)Hz U_N	230 V~	
Maximum continuous operating voltage U_c	275 V~	
Maximum discharge current (8/20 μ s) I_{max}	15 kA	
Nominal discharge current (8/20 μ s) I_n	5 kA	
Voltage protective level U_p	L-N	≤ 1.3 kV
	N-PE	≤ 0.5 kV
	L-PE	≤ 1.5 kV
Open circuit voltage U_{oc}	10 kV	
Response time t_A	L-N	≤ 25 ns
	N-PE	≤ 100 ns
Recommended back-up fuse	20 AgL/gG	
Thermal Cut-off Member	Internal	
Disconnection indicator	LED indicator	
Degree of protection	IP20	
Mounting type	35mm DIN rail acc. to EN 60715	
Housing material	UL94V-0	
Ambient temperature	-40°C ~+80°C	
Altitude	≤ 2000 m (amsl (above mean sea level))	
Permissible humidity	30%~90%	

FATECH ELECTRONIC (FOSHAN) CO., LTD.

Add: Bldg D7, Guangdong New Light Production Base, Luocun, Shishan Town, Nanhai District, Foshan City, Guangdong China.

Tel: +86 757 86718031 Fax: +86 757 83557686

Web: www.fatech-surge-protection.com, www.fatech-spd.cn

Email: sales@fatech-surge-protection.com, sales@fatech-spd.cn

5. Installation

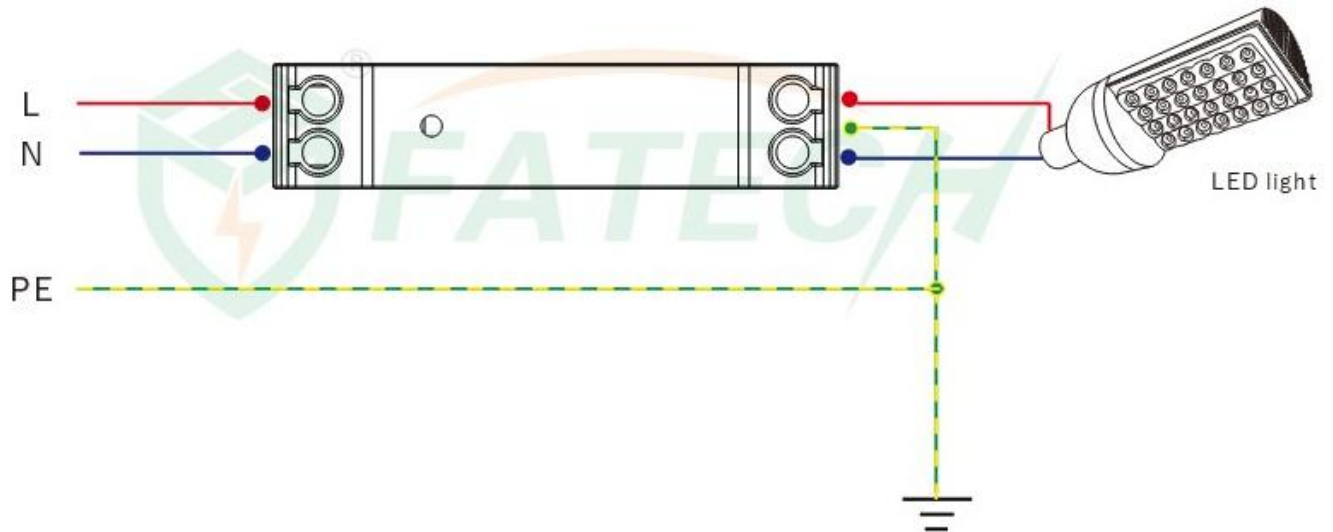

FATECH ELECTRONIC (FOSHAN) CO., LTD.

Add: Bldg D7, Guangdong New Light Production Base, Luocun, Shishan Town, Nanhai District, Foshan City, Guangdong China.

Tel: +86 757 86718031 Fax: +86 757 83557686

Web: www.fatech-surge-protection.com, www.fatech-spd.cn

Email: sales@fatech-surge-protection.com, sales@fatech-spd.cn